



## Wolsey Grove

Edgware

£550,000

A three bedroom, end-of-terraced house available with a south facing rear garden.

Downstairs the house has a double reception room, galley kitchen and rear conservatory leading to the south facing garden. The garden has a covered patio, lawn and studio/office.

Upstairs the house has three bedrooms and a family bathroom.

Barnet Council Tax Band D.

### Viewing

Please contact our Davidson Frost-Wellings Office on 020 8954 8806 if you wish to arrange a viewing appointment for this property or require further information.

- Three bedrooms
- South facing garden
- Garden studio
- No-through road
- End of terrace
- Freehold



3



1



2



D



Floor Plan

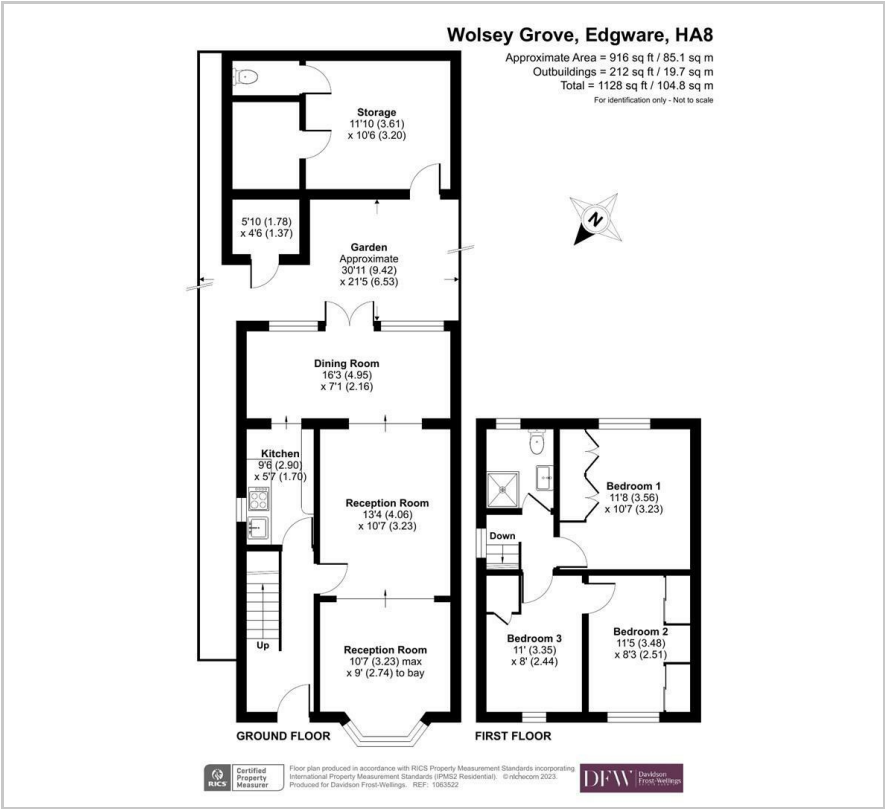

Area Map

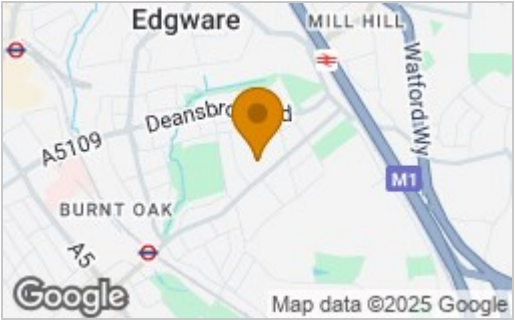

Energy Efficiency Rating		
	Current	Potential
Very energy efficient - lower running costs		
(92 plus) A		87
(81-91) B		
(69-80) C		
(55-68) D	66	
(39-54) E		
(21-38) F		
(1-20) G		
Not energy efficient - higher running costs		
England & Wales		EU Directive 2002/91/EC 



These particulars, whilst believed to be accurate are set out as a general outline only for guidance and do not constitute any part of an offer or contract. Intending purchasers should not rely on them as statements of representation of fact, but must satisfy themselves by inspection or otherwise as to their accuracy. No person in this firms employment has the authority to make or give any representation or warranty in respect of the property.